

BRAZOSPORT RELAY TRIATHLON BICYCLE ROUTE

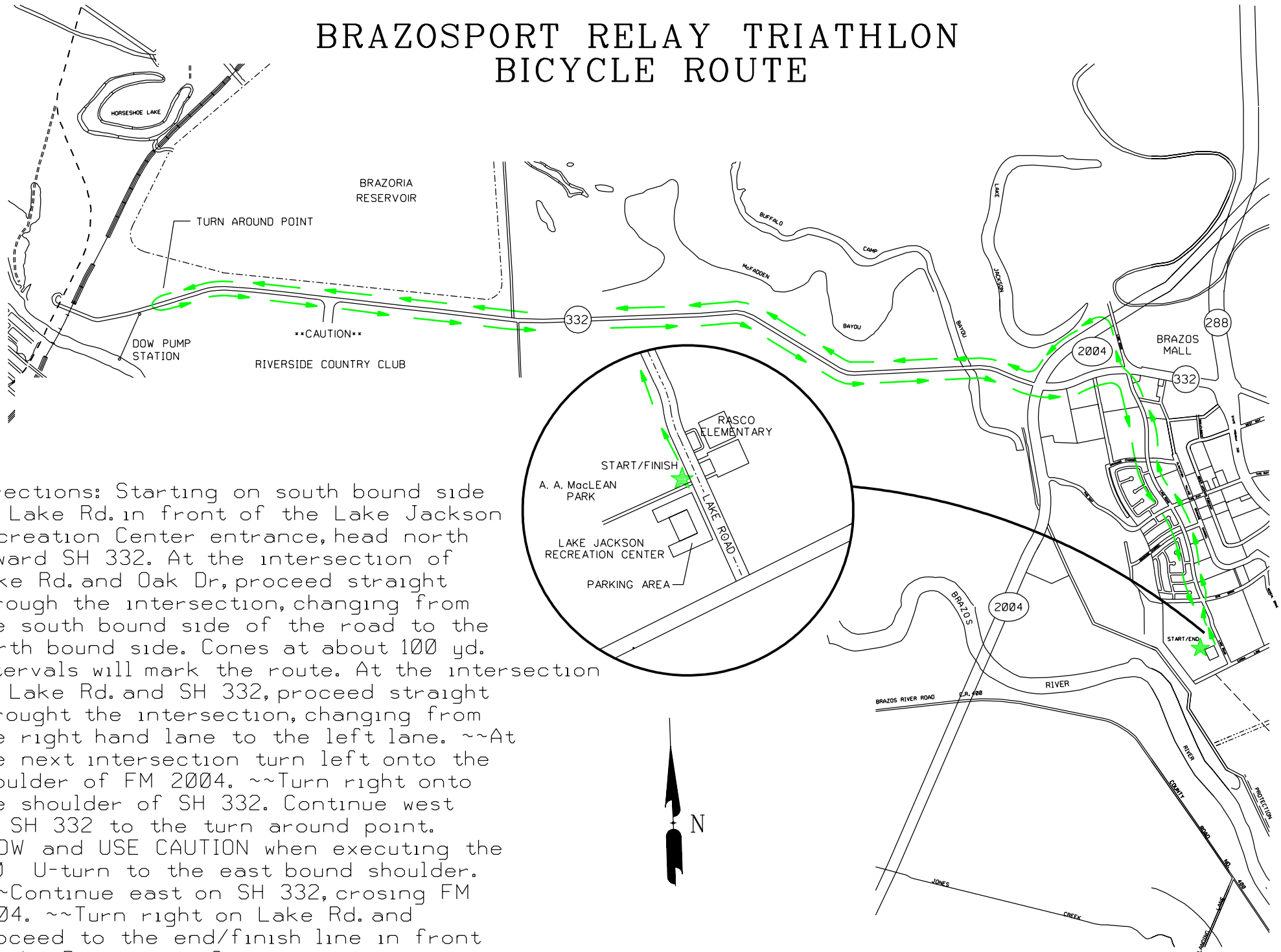

Directions: Starting on south bound side of Lake Rd. in front of the Lake Jackson Recreation Center entrance, head north toward SH 332. At the intersection of Lake Rd. and Oak Dr, proceed straight through the intersection, changing from the south bound side of the road to the north bound side. Cones at about 100 yd. intervals will mark the route. At the intersection of Lake Rd. and SH 332, proceed straight through the intersection, changing from the right hand lane to the left lane. ~At the next intersection turn left onto the shoulder of FM 2004. ~Turn right onto the shoulder of SH 332. Continue west on SH 332 to the turn around point. SLOW and USE CAUTION when executing the 180 U-turn to the east bound shoulder. ~Continue east on SH 332, crossing FM 2004. ~Turn right on Lake Rd. and proceed to the end/finish line in front of the Recreation Center.